

CYLINDERS

Standard Dimensions (Single-rod and Double-rod)

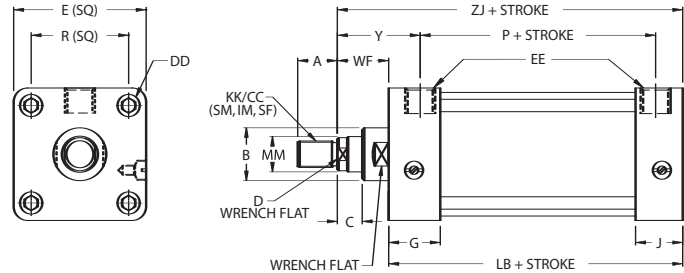

70MA2L325A008A1212 (shown above)



70MA6L325A008A1212 (shown above)

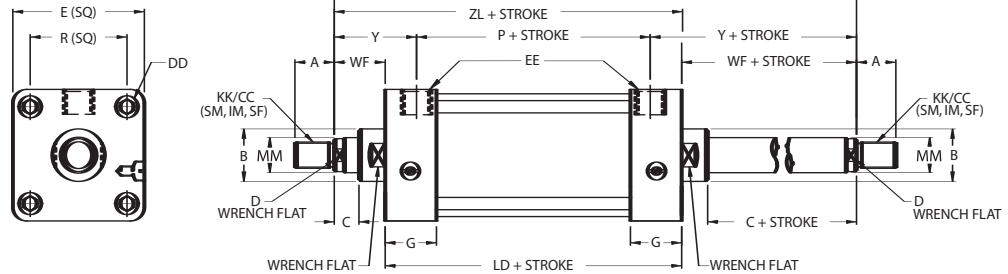

DIMENSIONS

BORE	Rod ø MM	Small Male SM Style 1 KK	Inter. Male IM Style 2 CC	Short Female SF Style 3 KK	A	B	C	D	DD	E	(NPTF) EE	G	J	LB+	LD+	P+	R	WF	Y	ZJ+	ZL+	ZM+ (2x Stroke)
1 1/2"	5/8"	7/16-20	1/2-20	7/16-20"	3/4"	1 1/8"	3/8"	1/2"	1/4-28	2"	3/8"	1.37"	0.87"	3 3/8"	4 1/8"	2.32"	1.43"	1"	1.79"	4 5/8"	5 1/8"	6 1/8"
2"	5/8"	7/16-20	1/2-20	7/16-20"	3/4"	1 1/8"	3/8"	1/2"	5/16-24	2 1/2"	3/8"	1.33"	0.83"	3 3/8"	4 1/8"	2.32"	1.84"	1"	1.79"	4 5/8"	5 1/8"	6 1/8"
	1"	3/4-16	7/8-14	3/4-16"	1 1/8"	1 1/2"	5/8"	7/8"	5/16-24	2 1/2"	3/8"	1.33"	0.83"	3 3/8"	4 1/8"	2.32"	1.84"	1 1/8"	2.15"	5"	5 1/8"	6 7/8"
2 1/2"	5/8"	7/16-20	1/2-20	7/16-20"	3/4"	1 1/8"	3/8"	1/2"	5/16-24	3"	3/8"	1.38"	0.88"	3 3/4"	4 1/4"	2.37"	2.19"	1"	1.75"	4 3/4"	5 1/4"	6 1/4"
	1"	3/4-16	7/8-14	3/4-16"	1 1/8"	1 1/2"	5/8"	7/8"	5/16-24	3"	3/8"	1.38"	0.88"	3 3/4"	4 1/4"	2.37"	2.19"	1 1/8"	2.15"	5 1/8"	5 5/8"	7"
3 3/4"	1"	3/4-16	7/8-14	3/4-16"	1 1/8"	1 1/2"	5/8"	7/8"	3/8-24	3 3/4"	1/2"	1.61"	1.11"	4 1/4"	4 3/4"	2.63"	2.76"	1 3/8"	2.25"	5 5/8"	6 1/8"	7 1/2"
	1 3/8"	1-14	1 1/4-12	1-14"	1 5/8"	2"	7/8"	1 1/8"	3/8-24	3 3/4"	1/2"	1.61"	1.11"	4 1/4"	4 3/4"	2.63"	2.76"	1 5/8"	2.49"	5 7/8"	6 3/8"	8"
4"	1"	3/4-16	7/8-14	3/4-16"	1 1/8"	1 1/2"	5/8"	7/8"	3/8-24	4 1/2"	1/2"	1.61"	1.11"	4 1/4"	4 3/4"	2.63"	3.32"	1 3/8"	2.48"	5 5/8"	6 1/8"	7 1/2"
	1 3/8"	1-14	1 1/4-12	1-14"	1 5/8"	2"	7/8"	1 1/8"	3/8-24	4 1/2"	1/2"	1.61"	1.11"	4 1/4"	4 3/4"	2.63"	3.32"	1 5/8"	2.49"	5 7/8"	6 3/8"	8"
5"	1"	3/4-16	7/8-14	3/4-16"	1 1/8"	1 1/2"	5/8"	7/8"	1/2-20	5 1/2"	1/2"	1.58"	1.06"	4 1/2"	5"	2.87"	4.10"	1 3/8"	2.25"	5 7/8"	6 3/8"	7 3/4"
	1 3/8"	1-14	1 1/4-12	1-14"	1 5/8"	2"	7/8"	1 1/8"	1/2-20	5 1/2"	1/2"	1.58"	1.06"	4 1/2"	5"	2.87"	4.10"	1 5/8"	2.50"	6 1/8"	6 5/8"	8 1/4"



CYLINDERS

Male Rod Thread Dimensions - Small Male, (Type SM) Style 1

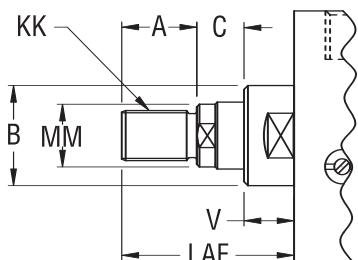

DIMENSIONS							
Bore	MM	KK	A	B	C	V	LAF
1½"	5/8"	7/16-20	3/4"	1½"	3/8"	5/8"	1¾"
2"	5/8"	7/16-20	3/4"	1½"	3/8"	5/8"	1¾"
	1"	3/4-16	1½"	1½"	5/8"	3/4"	2½"
2½"	5/8"	7/16-20	3/4"	1½"	3/8"	5/8"	1¾"
	1"	3/4-16	1½"	1½"	5/8"	3/4"	2½"
3¼"	1"	3/4-16	1½"	1½"	5/8"	3/4"	2½"
	1¾"	1-14	1½"	2"	7/8"	3/4"	3¼"
4"	1"	3/4-16	1½"	1½"	5/8"	3/4"	2½"
	1¾"	1-14	1½"	2"	7/8"	3/4"	3¼"
5"	1"	3/4-16	1½"	1½"	5/8"	3/4"	2½"
	1¾"	1-14	1½"	2"	7/8"	3/4"	3¼"

Male Rod Thread Dimensions - Intermediate Male, (Type IM) Style 2

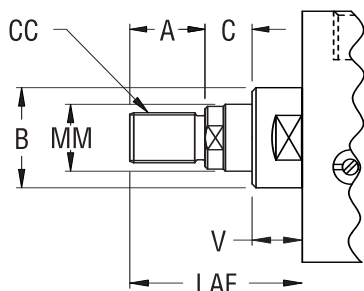

DIMENSIONS							
Bore	MM	CC	A	B	C	V	LAF
1½"	5/8"	½-20	3/4"	1½"	3/8"	5/8"	1¾"
2"	5/8"	½-20	3/4"	1½"	3/8"	5/8"	1¾"
	1"	7/8-14	1½"	1½"	5/8"	3/4"	2½"
2½"	5/8"	½-20	3/4"	1½"	3/8"	5/8"	1¾"
	1"	7/8-14	1½"	1½"	5/8"	3/4"	2½"
3¼"	1"	7/8-14	1½"	1½"	5/8"	3/4"	2½"
	1¾"	1¼-12	1½"	2"	7/8"	3/4"	3¼"
4"	1"	7/8-14	1½"	1½"	5/8"	3/4"	2½"
	1¾"	1¼-12	1½"	2"	7/8"	3/4"	3¼"
5"	1"	7/8-14	1½"	1½"	5/8"	3/4"	2½"
	1¾"	1¼-12	1½"	2"	7/8"	3/4"	3¼"

Female Rod Thread Dimensions - Short Female, (Type SF) Style 3

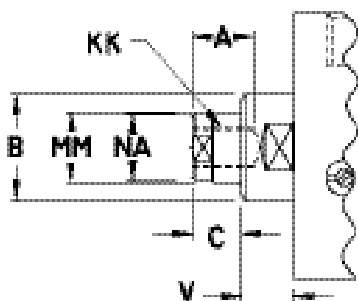

DIMENSIONS							
Bore	MM	KK	A	B	C	NA	V
1½"	5/8"	7/16-20	3/4"	1½"	3/8"	.59"	5/8"
2"	5/8"	7/16-20	3/4"	1½"	3/8"	.59"	5/8"
	1"	3/4-16	1½"	1½"	5/8"	.94"	3/4"
2½"	5/8"	7/16-20	3/4"	1½"	3/8"	.59"	5/8"
	1"	3/4-16	1½"	1½"	5/8"	.94"	3/4"
3¼"	1"	3/4-16	1½"	1½"	5/8"	.94"	3/4"
	1¾"	1-14	1½"	2"	7/8"	1.34"	3/4"
4"	1"	3/4-16	1½"	1½"	5/8"	.94"	3/4"
	1¾"	1-14	1½"	2"	7/8"	1.34"	3/4"
5"	1"	3/4-16	1½"	1½"	5/8"	.94"	3/4"
	1¾"	1-14	1½"	2"	7/8"	1.34"	3/4"

The company reserves the right to vary models and dimensions without notice. These products are designed for industrial applications and are not suitable for sale to the general public.

