

Rear trunnion, female Mod. C..... and CH...

Material: aluminium.
 The following is supplied:
 N° 1 cerniera femmina
 N° 4 screws

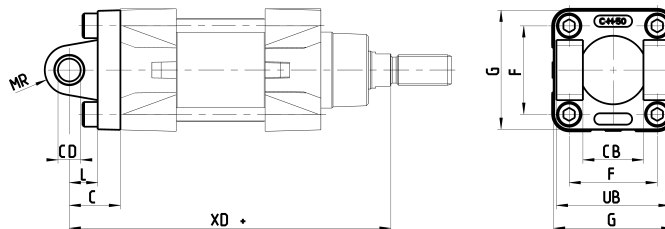

(+ add the stroke)

DIMENSIONS										
Mod.	∅	CD ^{H9}	L	C	XD±1.6	MR	F	G	CB H14	UB h14
C-41-32	32	10	12	22	142	9	32,5	45	26	45
C-41-40	40	12	15	25	160	13	38	52	28	52
C-41-50	50	12	15	27	170	13	46,5	63	32	60
C-H-41-63	63	16	20	32	190	15	56,5	73	40	70
C-H-41-80	80	16	24	36	210	15	72	95	50	90
C-H-41-100	100	20	29	41	230	18	89	115	60	110
C-H-41-125	125	25	30	50	275	25	110	135	70	130

Rear trunnion, male Mod. L...

Material: aluminium.
 The following is supplied:
 N° 2 cerniera maschio
 N° 4 screws

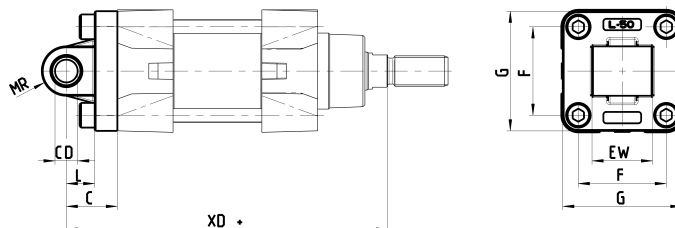

(+ add the stroke)

DIMENSIONS										
Mod.	∅	CD ^{H9}	L	C	XD±1.6	MR	F	G	EW -0.2 -0.6	
L-41-32	32	10	12	22	142	9	32,5	45	26	
L-41-40	40	12	15	25	160	13	38	52	28	
L-41-50	50	12	15	27	170	13	46,5	63	32	
L-41-63	63	16	20	32	190	15	56,5	73	40	
L-41-80	80	16	24	36	210	15	72	95	50	
L-41-100	100	20	29	41	230	18	89	115	60	
L-41-125	125	25	30	50	275	25	110	135	70	