

Rear trunnion, male Mod. L...

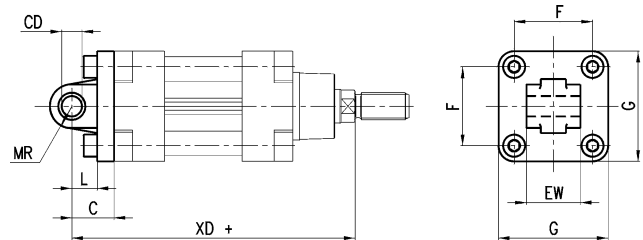

(+ add the stroke)

DIMENSIONS

Mod.	∅	CD H9	L	C ± 1.6	XD	MR	F	G	EW -0.2 -0.6
L-41-32	32	10	12	22	142	9	32.5	45	26
L-41-40	40	12	15	25	160	13	38	52	28
L-41-50	50	12	15	27	170	13	46.5	63	32
L-41-63	63	16	20	32	190	15	56.5	73	40
L-41-80	80	16	24	36	210	15	72	95	50
L-41-100	100	20	29	41	230	18	89	115	60
L-41-125	125	25	30	50	275	25	110	135	70
L-41-160	160	30	35	55	315	30	140	175	90
L-41-200	200	30	35	60	335	30	175	215	90

Front trunnion, female Mod. H...

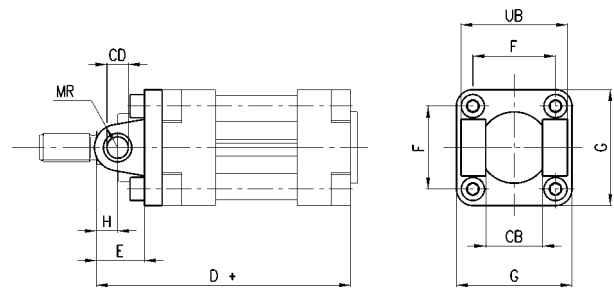

(+ add the stroke)

DIMENSIONS

Mod.	∅	CD H9	E	H	D	MR	F	G	CB H14	UB h14
H-41-32	32	10	16	4	120	9	32.5	45	26	45
H-41-40	40	12	20	5	135	13	38	52	28	52
H-41-50	50	12	25	10	143	13	46.5	63	32	60
C-H-41-63	63	16	25	5	158	15	56.5	73	40	70
C-H-41-80	80	16	34	10	174	15	72	95	50	90
C-H-41-100	100	20	39	10	189	18	89	115	60	110
C-H-41-125	125	25	45	15	225	25	110	135	70	130
C-H-41-160	160	30	60	25	260	30	140	175	90	170
C-H-41-200	200	30	70	35	275	30	175	215	90	170