

Rod Fork End G...

ISO 8140.
Material: zinc-plated steel.

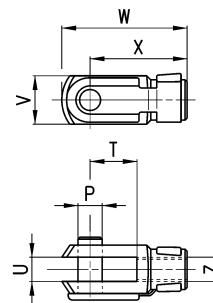

DIMENSIONS

Mod.	ø	P	T	U	V	W	X	Z
G-25-32	32	10	20	10	20	52	40	M10x1,25
G-40	40	12	24	12	24	62	48	M12x1,25
G-50-63	50-63	16	32	16	32	83	64	M16x1,5
G-80-100	80-100	20	40	20	40	105	80	M20x1,5
G-41-125	125	30	55	30	55	148	110	M27x2

Swivel Ball Joint Mod. GA...

ISO 8139.
Material: zinc-plated steel.

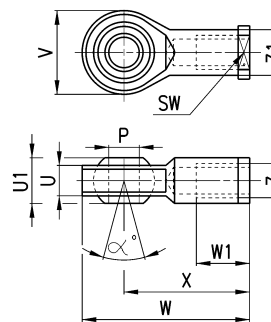

DIMENSIONS

Mod	ø	øP (H7)	U	U1	V	W	W1	X	Z	Z1	α°	SW
GA-32	32	10	10,5	14	28	57	20	43	M10x1,25	15	8	17
GA-40	40	12	12	16	32	66	22	50	M12x1,25	17,5	8	19
GA-50-63	50-63	16	15	21	42	85	28	64	M16x1,5	22	8,5	22
GA-80-100	80-100	20	18	25	50	102	33	77	M20x1,5	27,5	9	30
GA-41-125	125	30	25	37	70	145	51	110	M27x2	40	17	41

Piston Rod Socket Joint Mod. GY...

Material: aluminium and zinc-plated steel.

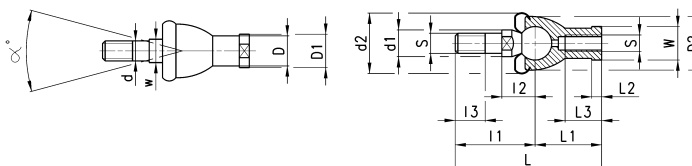

DIMENSIONS

Mod.	ø	S	L	L1	L2	L3	W	w	I1	I2	I3	D	D1	d	d1	d2	α°
GY-32	25-32	M10x1,25	74,5	35	6,5	18	17	11	39,5	19,5	15	15	19	10	14	32	30°
GY-40	40	M12x1,25	84	40	6,5	20	19	17	45	22	17	17,5	22	12	19	36	30°
GY-50-63	50-63	M16x1,5	112	50	8	27	22	19	64	27,5	23	22	27	16	22	47	22°
GY-80-100	80-100	M20x1,5	133	63	10	38	30	24	72,5	31,5	25	27,5	34	20	29	58	15°