

Front and rear flange Mod. D-E...

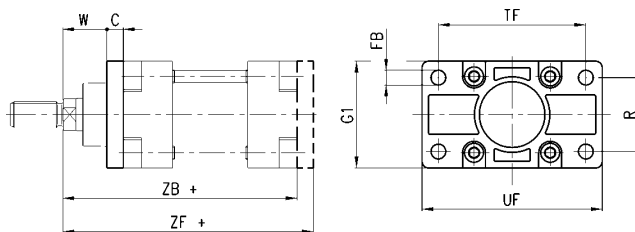

(+ add the stroke)

DIMENSIONS

Mod.	∅	W ± 2	C	ZB JS 14	TF JS 14	R JS 14	UF	G1	FB H 13	ZF ± 1,25
D-E-41-32	32	16	10	120	64	32	86	45	7	130
D-E-41-40	40	20	10	135	72	36	88	52	9	145
D-E-41-50	50	25	12	143	90	45	110	63	9	155
D-E-41-63	63	25	12	158	100	50	116	73	9	170
D-E-41-80	80	30	16	174	126	63	148	95	12	190
D-E-41-100	100	35	16	189	150	75	176	115	14	205
D-E-41-125	125	45	20	225	180	90	224	135	16	245
D-E-41-160	160	60	20	260	230	115	276	175	18	280
D-E-41-200	200	70	25	275	270	135	312	215	22	300

Rear trunnion, female Mod. C...

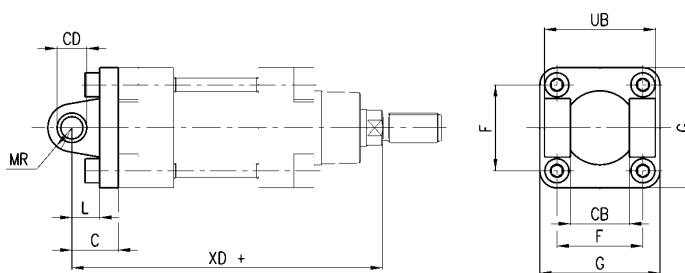

(+ add the stroke)

DIMENSIONS

Mod.	∅	CD H9	L	C	XD ± 1.6	MR	F	G	CB H14	UB h14
C-41-32	32	10	12	22	142	9	32.5	45	26	45
C-41-40	40	12	15	25	160	13	38	52	28	52
C-41-50	50	12	15	27	170	13	46.5	63	32	60
C-H-41-63	63	16	20	32	190	15	56.5	73	40	70
C-H-41-80	80	16	24	36	210	15	72	95	50	90
C-H-41-100	100	20	29	41	230	18	89	115	60	110
C-H-41-125	125	25	30	50	275	25	110	135	70	130
C-H-41-160	160	30	35	55	315	30	140	175	90	170
C-H-41-200	200	30	35	60	335	30	175	215	90	170